

PROLYTE H40D / H40V TRUSS

Photo : Prolyte Sales BV
Project : Media Centrale, Groningen, H40 truss

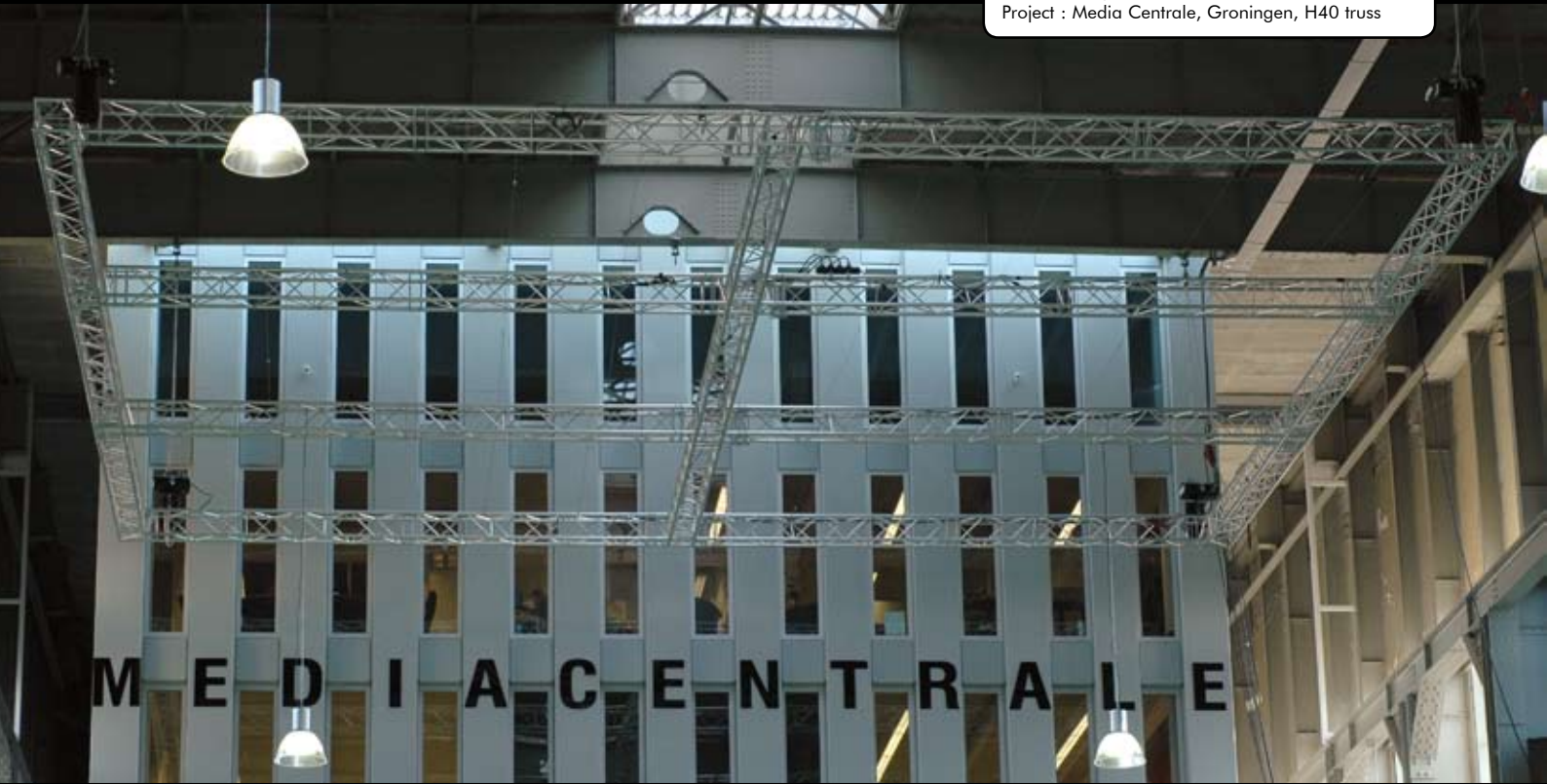

H40 truss is constructed of main tubes of 48,3 x 3 mm and diagonals of 20 x 2 mm. Use the CCS6 coupling system. Prolyte supplies a variety of H40 truss elements that provide

maximum flexibility, like standard or custom made lengths, circles and arches and several types of corners. Prolyte can deliver custom made pieces on request.



Prolyte H40L top view

Prolyte H40L side view

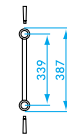
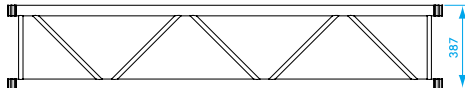

Prolyte H40D top view

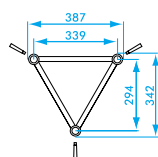
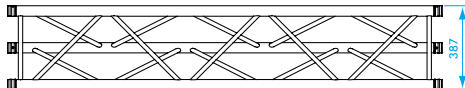

Prolyte H40D side view

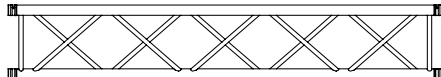

Prolyte H40V top view

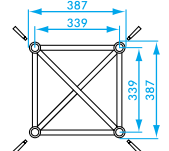
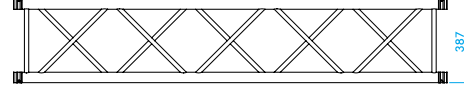

Prolyte H40V side view

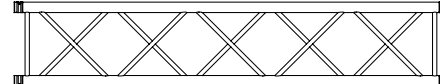

©PROLYTE SALES BV

PROLYTE H40D - ALLOWABLE LOADING

SPAN		UNIFORMLY DISTRIBUTED LOAD		DEFLECTION		MAXIMUM ALLOWABLE POINT LOADS									
						CENTRE POINT LOAD		DEFLECTION		SINGLE LOAD THIRD POINTS LOAD PER POINT		SINGLE LOAD FOURTH POINTS LOAD PER POINT		SINGLE LOAD FIFTH POINTS LOAD PER POINT	
m	ft	kg/m	lbs/ft	mm	inch	kg	lbs	mm	inch	kg	lbs	kg	lbs	kg	lbs
2	6,6	1103,1	742,34	3	0,12	1790,5	3951,7	2	0,08	1103,1	2434,6	733,7	1619,4	551,6	1217,3
3	9,8	733,7	493,7	6	0,24	1189,5	2625,3	5	0,20	892,1	1969,0	594,8	1312,6	493,7	1089,5
4	13,1	443,9	298,7	10	0,39	887,8	1959,3	8	0,31	665,8	1469,5	443,9	979,7	368,4	813,1
5	16,4	282,3	189,9	16	0,63	705,7	1557,5	13	0,51	529,3	1168,1	352,9	778,8	292,9	646,4
6	19,7	194,5	130,9	23	0,91	583,5	1287,8	18	0,71	437,6	965,9	291,8	643,9	242,2	534,4
7	23,0	141,6	95,3	31	1,22	495,5	1093,6	25	0,98	371,6	820,2	247,8	546,8	205,6	453,8
8	26,2	107,2	72,1	41	1,61	428,9	946,5	33	1,30	321,7	709,9	214,4	473,3	178,0	392,8
9	29,5	83,7	56,3	51	2,01	376,5	831,0	41	1,61	282,4	623,2	188,3	415,5	156,3	344,8
10	32,8	66,8	45,0	63	2,48	334,1	737,4	51	2,01	250,6	553,0	167,1	368,7	138,7	306,0
11	36,1	54,4	36,6	77	3,03	299,0	659,8	61	2,40	224,2	494,9	149,5	329,9	124,1	273,8
12	39,4	44,9	30,2	91	3,58	269,3	594,2	73	2,87	201,9	445,7	134,6	297,1	111,7	246,6
13	42,6	37,5	25,2	107	4,21	243,7	537,9	86	3,39	182,8	403,4	121,9	269,0	101,2	223,2
14	45,9	31,6	21,3	124	4,88	221,5	488,9	100	3,94	166,1	366,6	110,8	244,4	91,9	202,9
15	49,2	26,9	18,1	143	5,63	201,9	445,6	114	4,49	151,4	334,2	101,0	222,8	83,8	184,9
16	52,5	23,1	15,5	162	6,38	184,4	407,1	130	5,12	138,3	305,3	92,2	203,5	76,5	168,9
17	55,8	19,9	13,4	183	7,20	168,7	372,4	147	5,79	126,6	279,3	84,4	186,2	70,0	154,5
18	59,0	17,2	11,6	206	8,11	154,5	341,0	165	6,49	115,9	255,7	77,3	170,5	64,1	141,5
19	62,3	14,9	10,0	229	9,02	141,5	312,3	183	7,20	106,1	234,2	70,8	156,1	58,7	129,6
20	65,6	13,0	8,7	254	10	129,6	285,9	203	7,99	97,2	214,4	64,8	143,0	53,8	118,7

1 inch = 25.4 mm | 1m = 3.28 ft | 1 lbs = 0.453 kg

- Loading figures only valid for static loads and spans with two supporting points.
- Spans must be supported at each end.
- If dynamic loads, wind loads or more supporting points are applied contact a structural engineer or Prolyte.
- Loading figures are based on the German DIN standards. To comply to the BS and ANSI standards the loading data have to be multiplied with 0,85
- Self-weight of the trusses is already taken into account.
- For longer spans than indicated in the table, use KYLo or contact Prolyte to supply data on request.



Mark approval certificate No. 2253/04
 Test report No. 2252/04
 TÜV certification only valid for loading table above.

40 SERIES - STANDARD AVAILABLE LENGTHS AND CODES

Meters	Feet	Code
0,25 / 1,00 m in steps of 5 mm	0,82' / 3,28' in steps of 0,2"	
0,25	0,83	H40•-L025
0,30	0,98	H40•-L030
0,50	1,90	H40•-L050
0,75	2,46	H40•-L075
0,81	2,65	H40•-L081
1,50	4,57	H40•-L150
2,00	6,56	H40•-L200
2,50	8,20	H40•-L250
3,00	9,84	H40•-L300
3,50	11,48	H40•-L350
4,00	13,12	H40•-L400
4,50	14,76	H40•-L450
5,00	16,40	H40•-L500

*on • indicate L for ladder, D for triangle or V for Square truss. Example: H40V-L200

TECHNICAL SPECIFICATIONS H40 SERIES

Types	Ladder (L), Triangle (D), Square (V)
Alloy	EN AW 6082 T6
Main tubes (chords)	48,3 x 3 mm
Braces	20 x 2 mm
Coupling system	CCS6 series

Type		H40D	H40V	
Allowable Normal Force in Main Chord	N	30,54	30,54	kN
Allowable Normal Force in Diagonals	N	9,05	9,05	kN
Surface area Complete Truss	A	12,72	16,96	cm ²
Moment of Inertia Y-axis	Iy	2104,8	4179,5	cm ⁴
Moment of Inertia Z-axis	Iz	2089,8	4179,5	cm ⁴
Allowable bending moment Y-axis	My	8,98	20,70	kNm
Allowable bending moment Z-axis	Mz	10,35	20,70	kNm
Allowable shear force Z-axis	Qz/Vz	11,08	12,80	kN
Allowable shear force Y-axis	Qy/Vy	6,40	12,80	kN
Selfweight	kg	5	6,9	kg/m